

CATALOG #: _____

TYPE: _____

PROJECT: _____

FEATURES

- Slim 2-3/16" depth for shallow plenum applications
- Soft, low-glare, edge-lit optical performance
- Uniform ambient illumination
- Simple and quick installation
- Skylight kit creates architectural design aesthetic
- Surface mount kit provides design continuity where ceiling access is restricted
- Parabolic louver kit provides classic styling detail with modern performance specifications
- Seamless design prevents light leak
- Maximize energy savings with efficacies as high as 129 lm/W
- Shipped in 2-packs to reduce job-site waste
- PMMA lens reduces the risk of yellowing from UV exposure
- Available on QuickShip for immediate project requirements

SPECIFICATIONS

- HOUSING – Seam-welded, precision die-formed aluminum.
- OPTICS – Edge-lit PMMA light guide panel.
- FINISH – Non-glare matte white polyester powder coat. All parts painted after fabrication to facilitate installation, increase efficiency, and inhibit corrosion.
- ELECTRICAL – High quality mid-power LED boards. L80 >50,000 hours. -20°C minimum to 50°C maximum ambient operating temperature.
- MOUNTING – Designed for installation into NEMA Type "G" 1" grid ceiling. For 9/16" grid installations, specify EQCLIPS option. Skylight, surface mount, parabolic and drywall kit options available, shipped separately.
- LISTINGS –
 - Product is inherently IC-rated.
 - CULUS listed as LED luminaire suitable for dry or damp locations.
 - DesignLights Consortium qualified product. Not all versions of this product may be DLC qualified, see the DLC Qualified Products List at www.designlights.org/QPL.
- WARRANTY – 5-year limited fixture warranty, see hew.com/warranty.



ORDERING EXAMPLE: LP - 24 - L50/835 - OPTIONS - DIM - UNV

ORDERING INFO

SERIES	WIDTH	LENGTH	LUMENS ⁽¹⁾	CRI	CCT	OPTIONS ⁽²⁾
LP	1 1'	2 2' ⁽⁴⁾	1x4	8 80	35 3500K	EM/10WRM Remote mount 10-watt emergency battery ⁽⁷⁾
	2 2'	4 4'	L40 4,000lm		40 4000K	EQCLIPS Earthquake clips ⁽⁸⁾
			2x2 L40 4,000lm L50 5,000lm ⁽⁵⁾			DRYWALL FRAME-IN KITS ⁽⁹⁾ DFK-1248W Drywall kit, 12"x48", white DFK-2424W Drywall kit, 24"x24", white DFK-2448W Drywall kit, 24"x48", white
			2x4 L50 5,000lm L62 6,200lm ⁽⁶⁾			SURFACE MOUNT KITS ⁽¹⁰⁾ LP14SMK Surface mount kit, 1'x4' LP22SMK Surface mount kit, 2'x2' LP24SMK Surface mount kit, 2'x4'
						SKYLIGHT KITS ⁽¹¹⁾ LP142SL Skylight, 1'x4', 2" depth LP222SL Skylight, 2'x2', 2" depth LP242SL Skylight, 2'x4', 2" depth
						PARABOLIC LOUVER KITS ⁽¹²⁾ LP1416W Parabolic, 1'x4', 1x6, 6-cell, white LP1416S Parabolic, 1'x4', 1x6, 6-cell, semi-specular LP2233W Parabolic, 2'x2', 3x3, 9-cell, white LP2233S Parabolic, 2'x2', 3x3, 9-cell, semi-specular LP2244W Parabolic, 2'x2', 4x4, 16-cell, white LP2244S Parabolic, 2'x2', 4x4, 16-cell, semi-specular LP2426W Parabolic, 2'x4', 2x6, 12-cell, white LP2426S Parabolic, 2'x4', 2x6, 12-cell, semi-specular LP2436W Parabolic, 2'x4', 3x6, 18-cell, white LP2436S Parabolic, 2'x4', 3x6, 18-cell, semi-specular LP2448W Parabolic, 2'x4', 4x8, 32-cell, white LP2448S Parabolic, 2'x4', 4x8, 32-cell, semi-specular

DRIVER	VOLTAGE
DIM Dimming driver ⁽¹³⁾	UNV 120-277V

QUICKSHIP

1x4	2x2	2x4
LP-14-L40/835-QS-DIM-UNV	LP-22-L40/835-QS-DIM-UNV	LP-24-L50/835-QS-DIM-UNV
LP-14-L40/840-QS-DIM-UNV	LP-22-L40/840-QS-DIM-UNV	LP-24-L50/840-QS-DIM-UNV

NOTES

- ¹ Nominal lumen output based on 3500 CCT. Actual lumens may vary +/-5%, see page 2 for FIXTURE PERFORMANCE DATA.
- ² All options ship separately, field installed.
- ³ 4' length only.
- ⁴ 2' width only.
- ⁵ Extended lead times may apply. Consult factory for availability.
- ⁶ Extended lead times may apply. Consult factory for availability.
- ⁷ See page 4 for EM/10WRM DETAILS.
- ⁸ 4 per fixture. Optional for 1" grid installations. Required for 9/16" grid mounting.
- ⁹ See Technical Info at hew.com for Drywall Kit details. DFK and LP housing colors are not identical.
- ¹⁰ See page 4 for SURFACE MOUNT DETAILS.
- ¹¹ EQCLIPS standard, 4 per fixture. See page 4 for SKYLIGHT DETAILS.
- ¹² See page 5 for PARABOLIC LOUVER DETAILS. EQCLIPS standard, 4 per fixture.
- ¹³ Dimming driver prewired for 0-10V low voltage applications.

FIXTURE PERFORMANCE DATA

STANDARD

	LED PACKAGE	DELIVERED LUMENS	WATTAGE	EFFICACY (lm/W)
1x4	L40	4029	39.7	101.5
	L40	4155	39.2	106.0
2x2	L50	4965	39.9	124.4
	L50	4906	48.1	102.0
2x4	L62	6115	47.3	129.3

MULTIPLIER TABLE

COLOR TEMPERATURE	
CCT	CONVERSION FACTOR
3500K	1.00
4000K	1.03

- Photometrics tested in accordance with IESNA LM-79. Results shown are based on 25°C ambient temperature.
- Wattage shown is average for 120V through 277V input.
- Results based on 3500K, 80 CRI, actual lumens may vary +/-5%
- Use multiplier table to calculate additional options.

PARABOLIC LOUVER OPTION

	LED PACKAGE	CELL COMBINATION	DELIVERED LUMENS		WATTAGE	EFFICACY (lm/W)	
			LOUVER FINISH			LOUVER FINISH	
			WHITE	SEMI-SPEC	WHITE	SEMI-SPEC	
1x4	L40	1x6	3561	3349	39.7	89.7	84.4
		3x3	3495	3218	39.2	89.2	82.1
2x2	L40	4x4	3304	2974	39.2	84.3	75.9
		3x3	4176	3845	39.9	104.7	96.4
	L50	4x4	3952	3557	39.9	99.0	89.1
		2x6	4032	3758	48.1	83.8	78.1
2x4	L50	3x6	3922	3604	48.1	81.5	74.9
		4x8	3674	3301	48.1	76.4	68.6
		2x6	5025	4684	47.3	106.2	99.0
	L62	3x6	4888	4492	47.3	103.3	95.0
		4x8	4579	4114	47.3	96.8	87.0

PHOTOMETRY

LP-14-L40/835-DIM-UNV Total Luminaire Output: 4029 lumens; 39.7 Watts | Efficacy: 101.5 lm/W

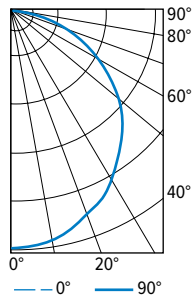

CANDLEPOWER DISTRIBUTION	VERTICAL ANGLE	HORIZONTAL ANGLE			ZONAL LUMENS
		0°	45°	90°	
	0	1432	1432	1432	
	5	1433	1433	1433	136
	15	1379	1381	1384	388
	25	1271	1278	1282	584
	35	1101	1107	1114	695
	45	938	948	951	727
	55	719	720	725	646
	65	504	504	501	492
	75	261	255	257	278
	85	73	70	67	83
	90	5	6	5	

LUMEN SUMMARY	ZONE	LUMENS	% FIXTURE
	0 - 30	1108	28
	0 - 40	1803	45
	0 - 60	3175	79
	0 - 90	4029	100
	0 - 180	4029	100

LP-22-L40/835-DIM-UNV Total Luminaire Output: 4155 lumens; 39.2 Watts | Efficacy: 106.0 lm/W

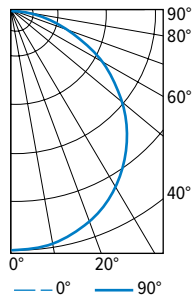

CANDLEPOWER DISTRIBUTION	VERTICAL ANGLE	HORIZONTAL ANGLE			ZONAL LUMENS
		0°	45°	90°	
	0	1463	1463	1463	
	5	1464	1457	1453	139
	15	1415	1406	1403	397
	25	1317	1310	1308	604
	35	1168	1163	1162	729
	45	987	977	980	756
	55	764	753	758	676
	65	517	514	507	507
	75	270	262	261	280
	85	53	47	48	67
	90	0	1	0	

LUMEN SUMMARY	ZONE	LUMENS	% FIXTURE
	0 - 30	1140	27
	0 - 40	1868	45
	0 - 60	3301	79
	0 - 90	4155	100
	0 - 180	4155	100

LP-24-L50/835-DIM-UNV Total Luminaire Output: 4906 lumens; 48.1 Watts | Efficacy: 102.0 lm/W

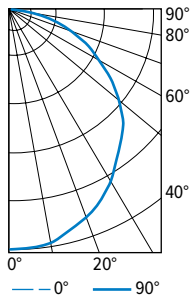

CANDLEPOWER DISTRIBUTION	VERTICAL ANGLE	HORIZONTAL ANGLE			ZONAL LUMENS
		0°	45°	90°	
	0	1732	1732	1732	
	5	1727	1724	1724	164
	15	1645	1648	1653	467
	25	1530	1539	1548	707
	35	1324	1338	1355	842
	45	1153	1170	1187	894
	55	879	891	903	794
	65	615	619	625	605
	75	315	313	313	336
	85	88	85	83	97
	90	7	5	5	

LUMEN SUMMARY	ZONE	LUMENS	% FIXTURE
	0 - 30	1338	27
	0 - 40	2180	44
	0 - 60	3868	79
	0 - 90	4906	100
	0 - 180	4906	100

LP-24-L62/835-LP2436S-DIM Report #: 13374551; 06/12/20 | Total Luminaire Output: 4492 lumens; 46.8 Watts | Efficacy: 95.8 lm/W

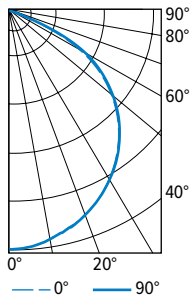

CANDLEPOWER DISTRIBUTION	VERTICAL ANGLE	HORIZONTAL ANGLE			ZONAL LUMENS
		0°	45°	90°	
	0	1953	1953	1953	
	5	1941	1939	1940	137
	15	1839	1828	1835	296
	25	1690	1650	1688	409
	35	1484	1425	1475	461
	45	1224	1153	1209	444
	55	903	815	875	344
	65	429	383	367	132
	75	56	55	56	20
	85	10	9	11	3
	90	1	2	2	

LUMEN SUMMARY	ZONE	LUMENS	% FIXTURE
	0 - 40	2374	53
	0 - 60	4028	90
	0 - 90	4492	100
	90 - 180	0	0

RECESSED DETAILS

BACKVIEW

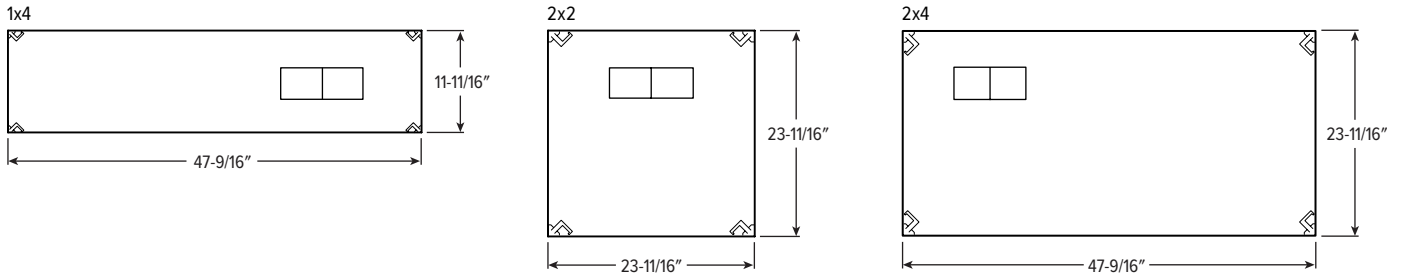

SIDE VIEW

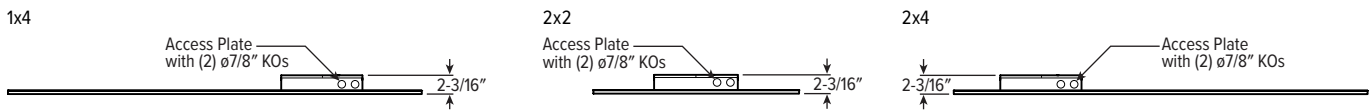

EM/10WRM DETAILS

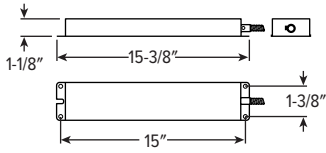

SURFACE MOUNT DETAILS



2x2 Shown

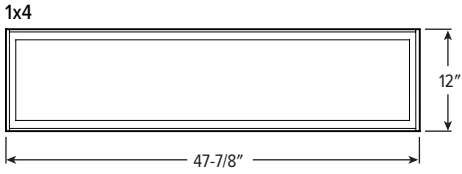
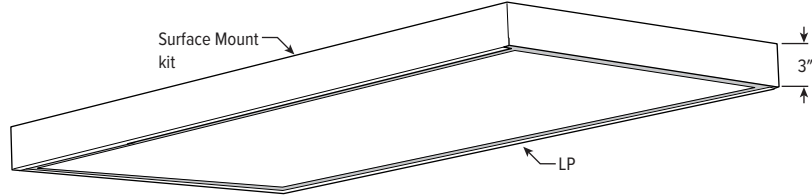

1x4

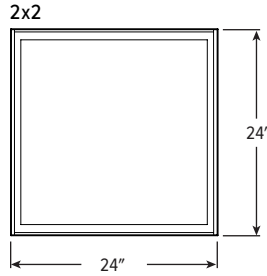

2x2

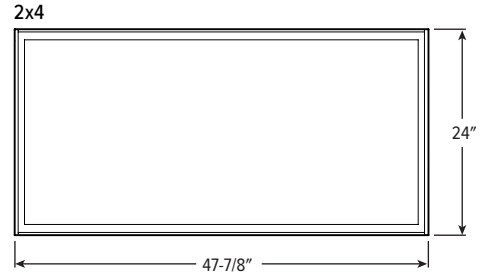

2x4

SKYLIGHT DETAILS



2x2 Shown

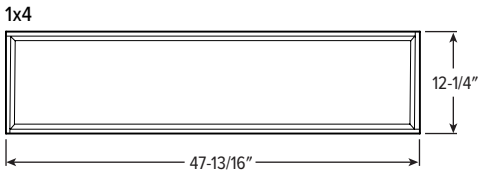
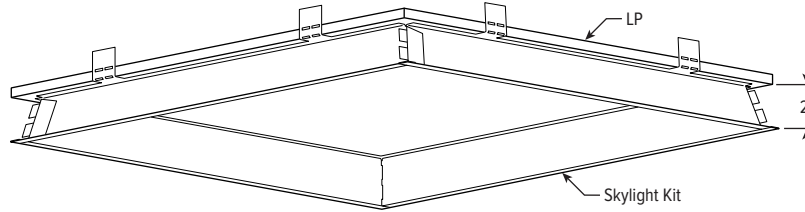

1x4

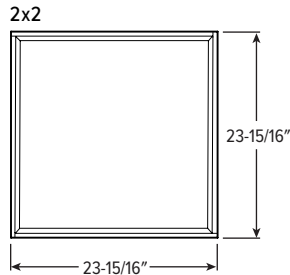

2x2

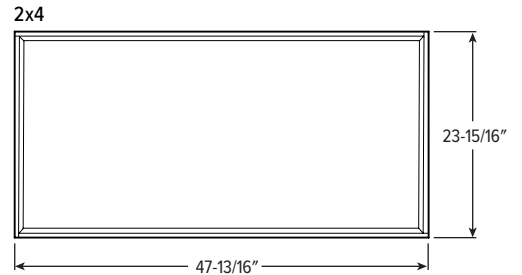

2x4

PARABOLIC LOUVER DETAILS

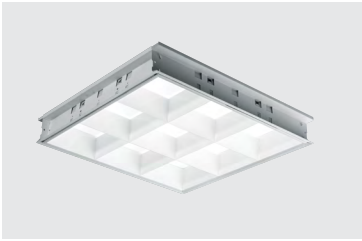

2x2 Shown

