

Attachment A

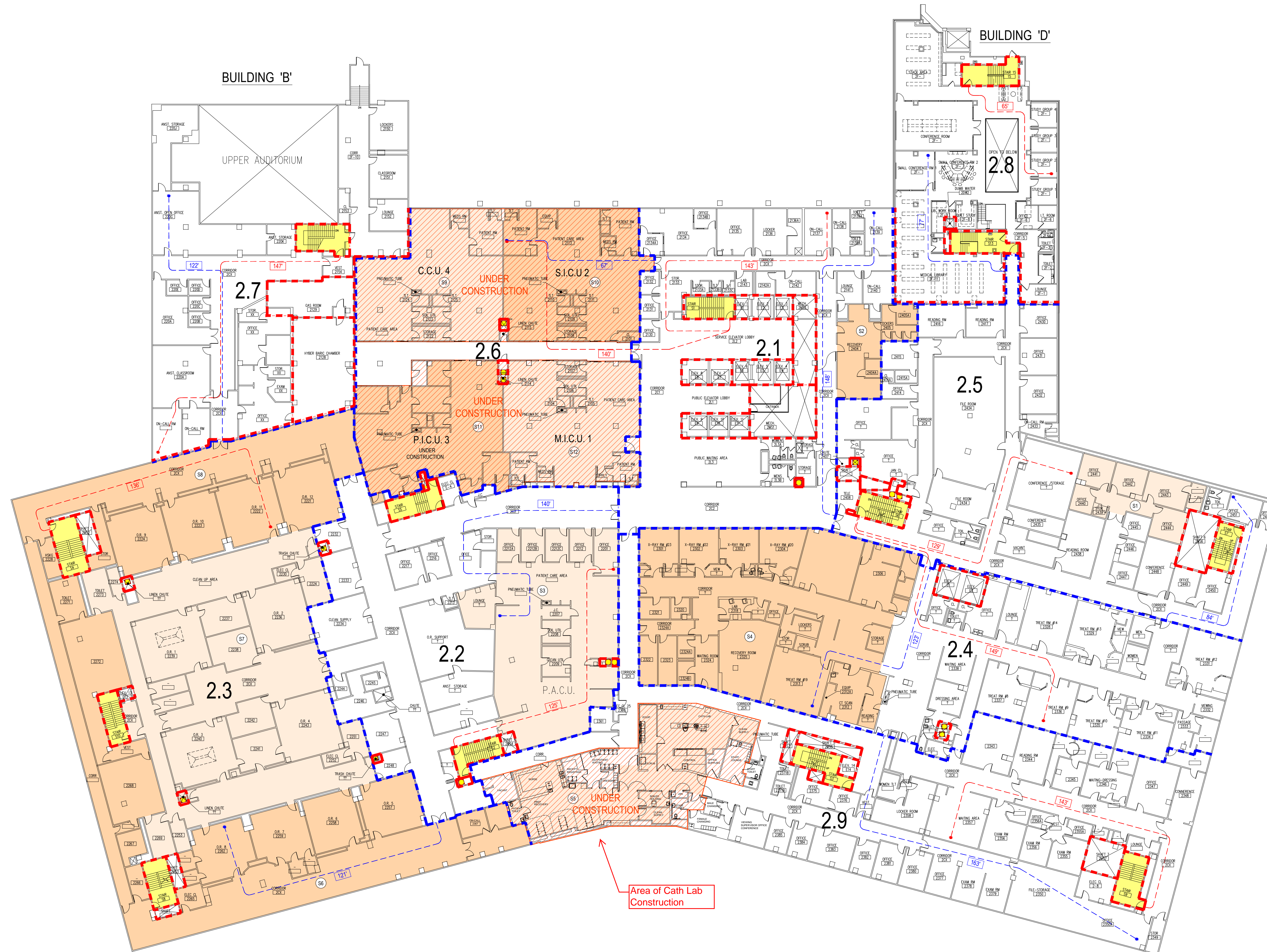

LIFE SAFETY LEGEND

- - - - 2 HOUR FIRE BARRIER
- - - - 1 HOUR FIRE BARRIER
- - - - 30 MIN SMOKE BARRIER
- - - - 2 HOUR FIRE SMOKE BARRIER
- - - - 1 HOUR FIRE SMOKE BARRIER
- EXIT STAIRWELL
- SUITES
- EXIT DISCHARGE PASSAGEWAY
- AREA UNDER CONSTRUCTION
- ↖ EXTERIOR EXIT
- LINEN/ TRASH CHUTE
- HZ HAZARDOUS AREA
- HZ HAZARDOUS AREA (MULTIPLE ROOMS)
- - - - DISTANCE TO SMOKE BARRIER DOOR
- - - - DISTANCE TO EXIT
- S# SUITE ID
- 2.1 COMPARTMENT ID

SCHEDULES AND NOTES

2ND FLOOR - EXISTING HEALTHCARE OCCUPANCY

COMPARTMENT ID	COMPARTMENT SQ. FT.	OCCUPANT LOAD	SPRINKLER SYSTEM	AREA USE	DISTANCE SMOKE	DISTANCE EXIT
2.1	12,826	128	PARTIAL	BUSINESS USE	148'	143'
2.2	13,577	57	PARTIAL	TREATMENT	140'	125'
2.3	24,216	100	PARTIAL	TREATMENT	141'	132'
2.4	16,175	67	PARTIAL	TREATMENT	123'	149'
2.5	13,955	139	PARTIAL	BUSINESS USE	84'	129'
2.6	13,068	109	PARTIAL	PATIENT SLEEPING	67'	140'
2.7	9,677	96	PARTIAL	BUSINESS USE	122'	147'
2.8	6,566	66	PARTIAL	BUSINESS USE	77'	65'
2.9	18,334	76	PARTIAL	TREATMENT	163'	143'
TOTAL	128,394	838				

2ND FLOOR - SUITE INFORMATION

SUITE ID	SUITE SQ. FT.	SLEEPING/ NON SLEEPING	NUMBER OF INTERVENING RMS	REMOTE EXIT REQUIREMENTS	DISTANCE TO EXIT ACCESS DOOR
S1	1,120	NON SLEEPING	1	1 REMOTE EXIT	41'
S2	843	NON SLEEPING	1	1 REMOTE EXIT	39'
S3	4,439	NON SLEEPING	1	2 REMOTE EXITS	78'
S4	7,503	NON SLEEPING	1	2 REMOTE EXITS	65'
S5	2,548	NON SLEEPING	1	2 REMOTE EXITS	42'
S6	8,112	NON SLEEPING	1	2 REMOTE EXITS	97'
S7	9,315	NON SLEEPING	1	2 REMOTE EXITS	85'
S8	5,079	NON SLEEPING	1	2 REMOTE EXITS	85'
S9	2,867	SLEEPING	1	2 REMOTE EXITS	60'
S10	3,070	SLEEPING	1	2 REMOTE EXITS	64'
S11	2,843	SLEEPING	1	2 REMOTE EXITS	53'
S12	2,722	SLEEPING	1	2 REMOTE EXITS	47'

COMPARTMENT KEY PLAN

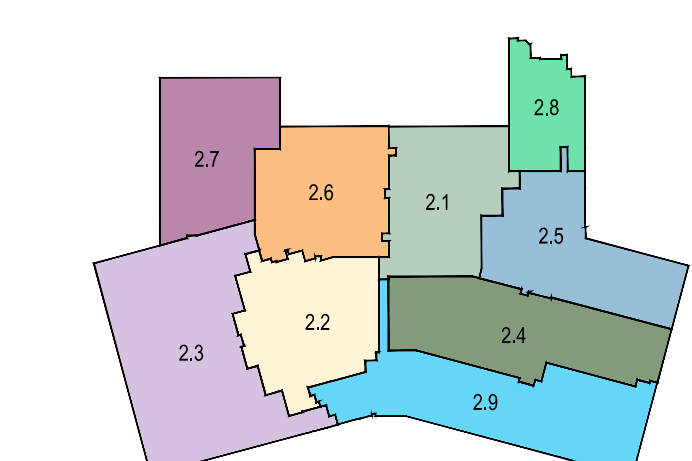

LIFE SAFETY
 PROJECT NO: 14096A
 FACILITY: NASSAU UNIVERSITY MEDICAL CENTER
 DYNAMIC CARE BUILDING
 DATE: 10-01-2014
 FLOOR: 2ND FLOOR
 DWG. NO: NUMC-DCB-SOC-02

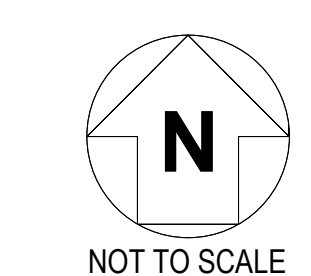

NOT TO SCALE